

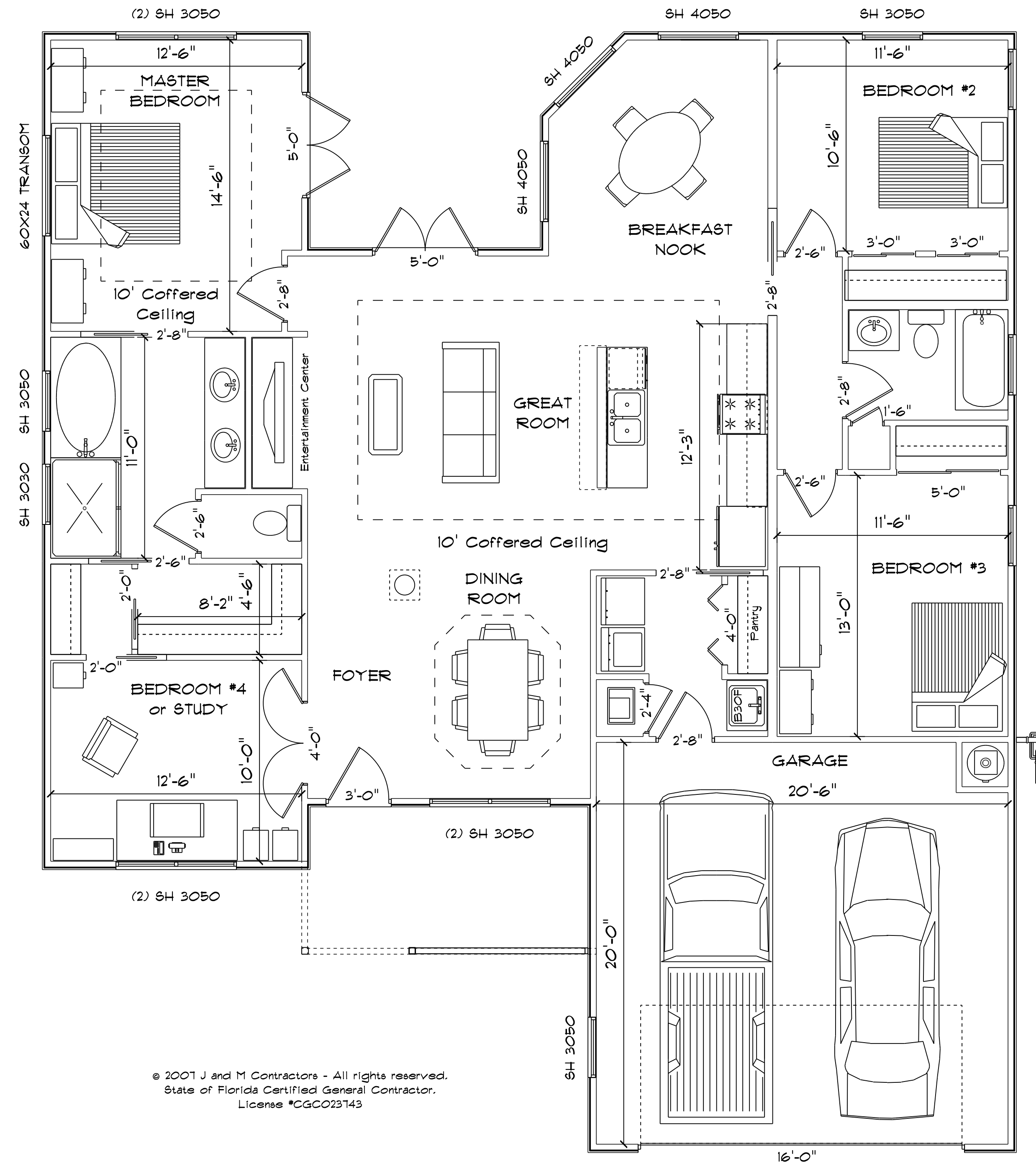

3 BEDROOM,
2 BATH,
STUDY/4th BEDROOM



WILLOW OAK PLANTATION



© 2007 J and M Contractors - All rights reserved.
State of Florida Certified General Contractor.
License #CGC023743

ALL WALLS 9", UNLESS OTHERWISE NOTED

AREAS IN SQUARE FEET
HEATED/COOLED 1714
GARAGE
FRONT PORCH
TOTAL SQ. FT.

WILLOW OAK
PLANTATION - Lot #32
7429 SW 87th Terrace
Gainesville, FL 32608

© 2007 J AND M CONTRACTORS
THESE DRAWINGS ARE THE SOLE OWNERSHIP OF
J AND M CONTRACTORS. ANY REPRODUCTION OF
THESE DRAWINGS WITHOUT EXPRESS WRITTEN
CONSENT IS FORBIDDEN AND WILL BE PROSECUTED
TO THE FULLEST EXTENT OF THE LAW.

Project Manager:
Leonard Sprague

Phone: (352) 262-4788
Fax: (352) 379-5974

Website: www.JandMContractors.com
Email: info@JandMContractors.com

DRAWN BY:
LEONARD SPRAGUE

CGC 023743
J&M CONTRACTORS
General Contractors · Construction Management · Residential Design

FLOOR PLANS
1/4" = 1'-0"
(unless otherwise noted)

SHEET
A1

REVISION DATE & TIME:
May 13, 2007 10:52 PM